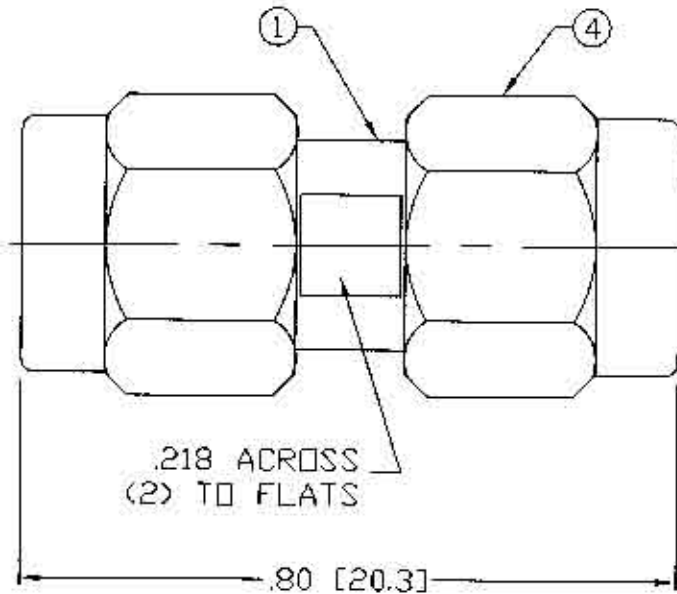

PART NUMBER

KAD177782

REV.

INITIAL

SPECIFICATIONS:IMPEDANCE RANGE: 50 OhmsFREQUENCY RANGE: DC to 34 GHzVSWR: $1.04 + .006 f$ (f=GHz) Max. DC-34 GHzCONTACT RESISTANCE:

Outer Contact= 2.0 milliohms

Center Contact= 3.0 milliohms

CONNECTOR DURABILITY: 500 Cycles minimumTEMPERATURE RANGE: -55° C TO 105° CMATERIALS:

Body and Body Components:

Non-Magnetic stainless steel, per ASTM
A582, class 303 condition A.Contacts: Beryllium copper,
per QQ-C-530, heat treated per
MIL-H-7199

Insulators: REXOLITE

FINISH:

Center Contacts:

.000050 min. gold per MIL-G-45204B
Type II, Grade C, Class 1
over .000050 min. Nickel per
QQ-N-290A

Other Metal Parts:

Passivated, (as specified)
to meet the finish and
corrosion requirements of MIL-C-39012.**Konnect RF**540 NW University Blvd. Ste. 109
Port Saint Lucie, Florida, 34986
1-800-790-5887

PART NUMBER

KAD177782

DESCRIPTION

**ADAPTER, IN-SERIES, 3.5mm MALE PLUG
to MALE PLUG, PRECISION**

CAGE CODE

664U0

SIGNATURE

X

NOTES

THIS DRAWING INCLUDING THE
DESIGNS IS THE PROPERTY OF
KONNECT RF AND IS NOT TO
BE USED FOR ANY PURPOSE
WITHOUT OUR APPROVAL.

| 1 | BODY | 1 | SST. 303 | PASSIVATE |
|---|----------------|-----|----------|-----------|
| 2 | CONTACT | 1 | Be.Cu. | GOLD, 50μ |
| 3 | CONTACT | 1 | Be.Cu. | GOLD, 50μ |
| 4 | COUPLING NUT | 2 | SST. 303 | PASSIVATE |
| 5 | BEAD | 1 | REXOLITE | ---- |
| 6 | RETAINING RING | 2 | Be.Cu. | ---- |
| 7 | GASKET | 2 | SILICONE | ---- |
| 8 | INSERT | 1 | SST. 303 | PASSIVATE |
| # | DESCRIPTION | QTY | MATERIAL | FINISH |