

PART NUMBER

KAD177281

REV.

INITIAL

Electrical Data

Impedance	50 Ohm
Frequency Range	DC-12.4GHz
Working Voltage	500 V rms @ sea level
Insulation Resistance	5k M Ohms min.
Temperature Range	-65°C to 85°C

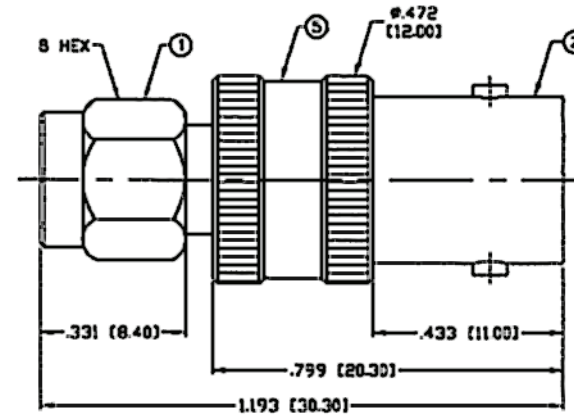
RoHS Compliant**Konnnect RF**

540 NW University Blvd. Ste. 109
Port Saint Lucie, Florida, 34986
1-800-790-5887

PART NUMBER

KAD177281

DESCRIPTION

**Adapter - Between Series
BNC Female Jack to SMA Male Plug**

CAGE CODE

664U0

SIGNATURE

X

THIS DRAWING INCLUDING THE
DESIGNS IS THE PROPERTY OF
KONNECT RF AND IS NOT TO
BE USED FOR ANY PURPOSE
WITHOUT OUR APPROVAL.

Materials

Insulator	PTFE	
Body	Brass	Nickel Plated
Contact	Phos. Broze	Gold Plated
Gasket	Silicone Rubber	
Shell	Brass	Nickel Plated
Retaining Ring	Be-Cu	